

Dot laser, red, 650 nm, 5 mW

LFD650-5-3(8x22)-3000H
Order Number: 70116144



Main Parameters (*)	min	typ	max	Unit
Wavelength		650		nm
Optical Diode Power		5		mW
Operating Voltage	2.6	3	3.3	V DC
Operating Current	10	20	30	mA
Operating Temperature	-10		40	°C
Storage Temperature	-40		80	°C

Main Data

Warranty 1 years

Technical Parameters

Lifetime >3,000 h
RoHS yes

Optical Parameters

Beam Shape	Dot
Laser Class	3R
Divergence	H - 1.0 mrad
Size of Laserdot	2.4@4m
Operating Distance	10 m
Optics	acryl lense
Laser technology	diode
Focus	adjustable

Electrical Parameters

Potential of Housing VDD(+)

Mechanical Parameters

Size	Ø8x22 mm
Material	Brass
Cable length	100 mm
Wire type	26AWG, 0,14mm ²
Output Aperture	3 mm
Weight	4.6 g

(*) Over the complete operating temperature range

Features

Picture

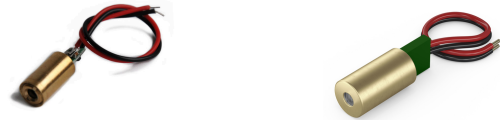

Cable color

Ground		black	GND
Positive		red	2.6 - 3.3, typ 3 V DC

Drawing

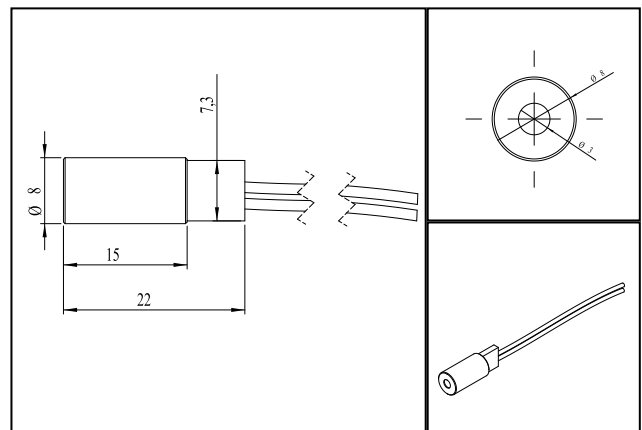

Safety Label



Valid Revision

9 | 19-NOV-2021