

DOE laser, red, 635 nm, 5 mW

DOE259-635-5-6(10x22)F300
Order Number: 70124255

Main Parameters (*)	min	typ	max	Unit
Wavelength		635		nm
Optical Diode Power		5		mW
Operating Voltage	3	5	6	V DC
Operating Current	25	45	65	mA
Operating Temperature	-20		50	°C
Storage Temperature	-40		80	°C

Main Data

Warranty 1 years

Technical Parameters

Lifetime >3,000 h
RoHS yes

Optical Parameters

Beam Shape DOE
Laser Class 1
Divergence H - 1.0 mrad
Line Thickness <1mm@300mm
Operating Distance 0.3 m
Optics acryl lense
Laser technology diode
Protection Lens yes
Focus fixed (300mm)

Electrical Parameters

Potential of Housing VDD(+)

Mechanical Parameters

Size Ø10x22 mm
Material Brass
Cable length 100 mm
Wire type 26AWG, 0,14mm²
Output Aperture 6 mm
Weight 8.5 g
Stripping of wire 5 mm

DOE

Alpha 28.2°
Beta 2.82°
a 5 mm
b 50.5 mm
Diameter (without holder) 8 mm
Width (without Holder) 1.2 mm

Material PC

(*) Over the complete operating temperature range

Features



Picture



Cable color

Ground  black GND
Positive  red 3 - 6, typ 5 V DC

Drawing

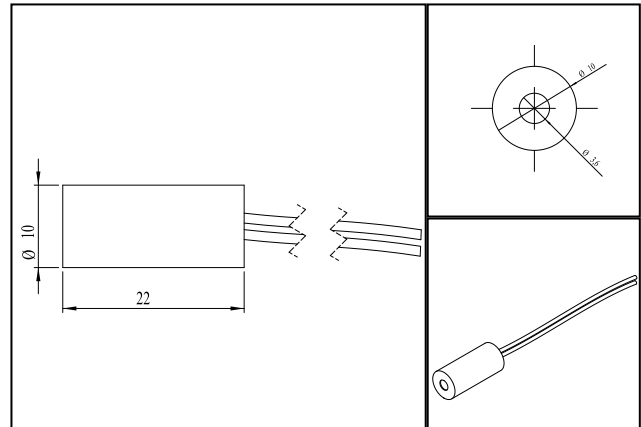

Safety Label



Valid Revision

| 14-JAN-2016