

Line laser, red, 650 nm, 50°, 16 mW

LFL650-16-3(16x90)-NT
Order Number: 70109726

Main Parameters (*)	min	typ	max	Unit
Wavelength		650		nm
Optical Output Power		16		mW
Operating Voltage	2.7	3	3.3	V DC
Operating Current		70		mA
Operating Temperature	-20		40	°C
Storage Temperature	-40		80	°C

Technical Parameters

Lifetime	>5000 h
RoHS	yes

Optical Parameters

Beam Shape	Line
Laser Class	2
Divergence	H - 1.0 mrad
Fan Angle	90°
Line Thickness	<1mm@3m
Operating Distance	3 m
Optics	glass lens AR coated
Laser technology	diode
Focus	fixed (3000mm)

Electrical Parameters

Potential of Housing	VDD(+)
Connector	2.5 mm DC plug (GND pole inner)
Power Supply	LFNT-3

Mechanical Parameters

Size	Ø16x90 mm
Material	aluminium
Cable length	1400 mm
Weight	46 g

(*) Over the complete operating temperature range

Features

- Laser Class 2
- High Power
- Image processing
- Low power consumption

Picture



Drawing

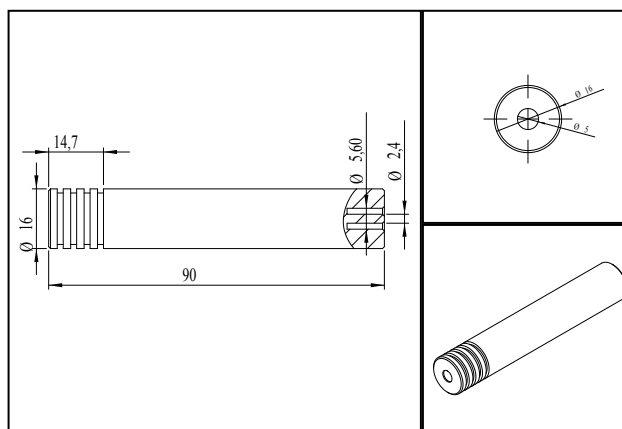

safety label

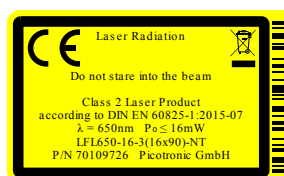

Valid Revision

REV 16 | 14-MAR-2018

Laserfuchs is a registered trademark of the Picotronic GmbH

Picotronic GmbH Rudolf-Diesel-Str. 2a 56070 Koblenz Germany	Geschäftsführende Gesellschafter: David Heckner, Thiemo Komischke	FON +49(0)261-983 497-50 FAX +49(0)261-983 497-55 www.laserfuchs.de info@laserfuchs.de	Sparkasse Koblenz BLZ 570 501 20, KTO 211 003 BIC / IBAN : MALADE51KOB DE41 5705 0120 0000 2110 03	Postbank Stuttgart BLZ 600 100 70, KTO 770 787 04 BIC / IBAN : PBNKDEFF DE41 6001 0070 0077 0787 04	Steuernummer: 22/651/0291/4 Ust-Idnr. DE814473445 Amtsgericht Koblenz HRB 20026 WEEE-Reg.-Nr. DE85231360
---	--	---	---	--	---