

Line laser, green, 532 nm, 90°, 50 mW

LD532-50-230(40x210)
Order Number: 70112764

Main Parameters (*)	min	typ	max	Unit
Wavelength		532		nm
Optical Output Power		50		mW
Operating Voltage	207	230	253	V AC
Operating Current	5	10	15	mA
Operating Temperature	15		30	°C
Storage Temperature	-40		80	°C

Main Data

Warranty 1 years

Technical Parameters

Lifetime > 10,000 h
RoHS yes

Optical Parameters

Beam Shape Line
Laser Class 2M
Divergence D - 0.5 mrad
Fan Angle 90°
Line Thickness <3mm@7m
Operating Distance 30 m
Optics glass lens AR coated
Beam Mode TEM00
Laser technology YVO4+KTP
Stability +/- 20% @ 15-30°C
Focus fixed (7.0m)
Warm up time < 15 min

Electrical Parameters

Potential of Housing isolated
Connector AC CEE 7/7

Mechanical Parameters

Size Ø40x210 mm
Material aluminium
Cable length 1,750 mm
Wire type H05VV-F
Output Aperture 8 mm
Weight 920 g

(*) Over the complete operating temperature range

Features



- Operating Voltage 230 V AC
- Glas lenses anti reflex coated
- Laser Class 2M
- High power
- Uniform line thickness

Picture



Montageplatte optional
Base Plate not included

Drawing

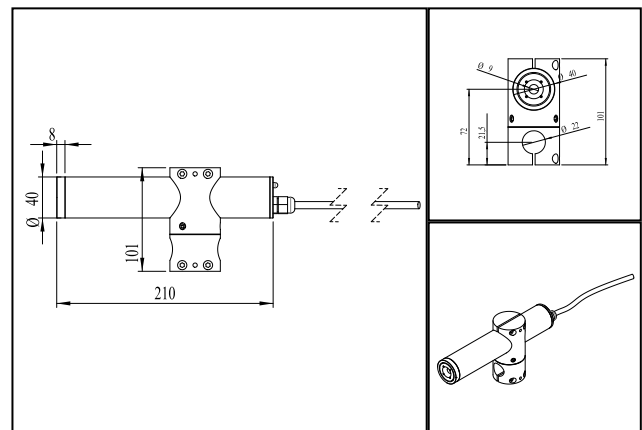

Safety Label



Valid Revision

7 | 08-SEP-2022